



# EKIPA

0094NOTIC6227



## Bas Four 63

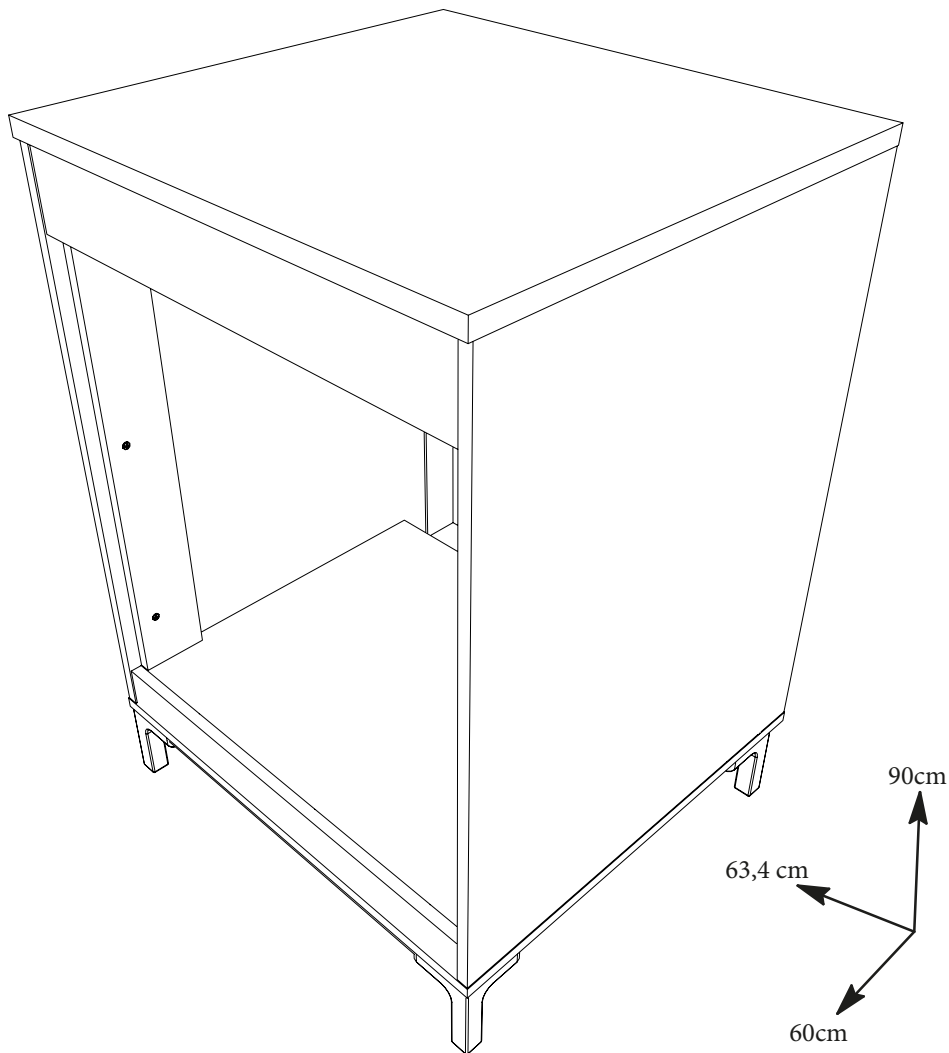

### **FR Remerciements :**

Nous vous remercions d'avoir choisi un meuble créé et fabriqué par Ekipa et espérons qu'il vous donnera entière satisfaction.

### **EN Thanks :**

Thank you for choosing furniture designed and manufactured by Ekipa. We hope you are totally satisfied your purchase.

### **ES Agradecimientos :**

Les damos las gracias por haber elegido un mueble diseñado y fabricado por el Ekipa y esperamos que sea de su total agrado.

### **DE Danksagung:**

Wir danken Ihnen für den Kauf eines Frankreich von der Ekipa entworfenen und hergestellten Möbelstücks und hoffen, dass Sie es zu Ihrer vollkommenen Zufriedenheit finden werden.



Temps de montage : 1h30 **contact@parisot.com**

## Conseils de préparation au montage : 15 min



<https://qrco.de/bcJeNz>

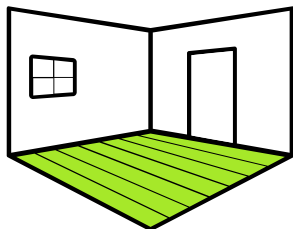

Faire un peu de place

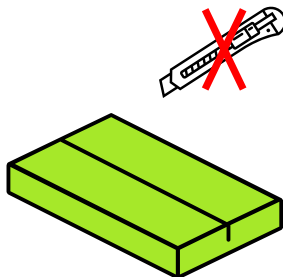

Pas d'outils tranchants

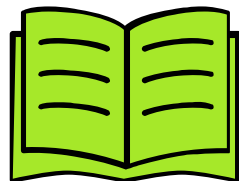

Bien suivre les instructions  
de la notice de montage

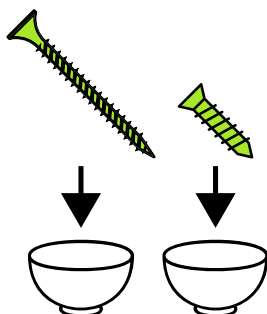

Trier vos quincailleries

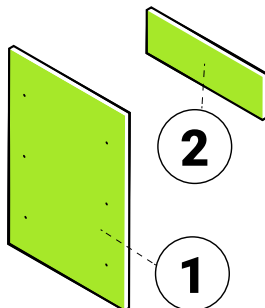

Repérer vos pièces

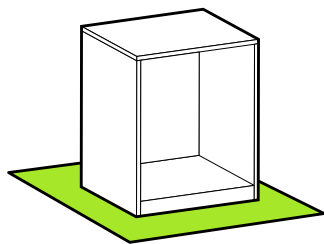

Protéger votre sol

## Matériel nécessaire

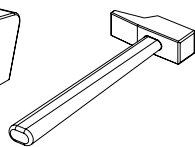
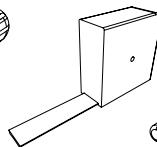
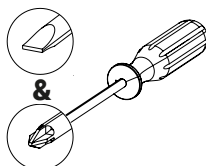
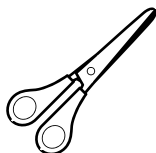
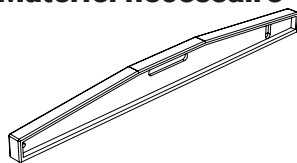

## Conseils d'entretien

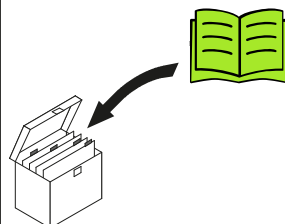

Repérer vos pièces

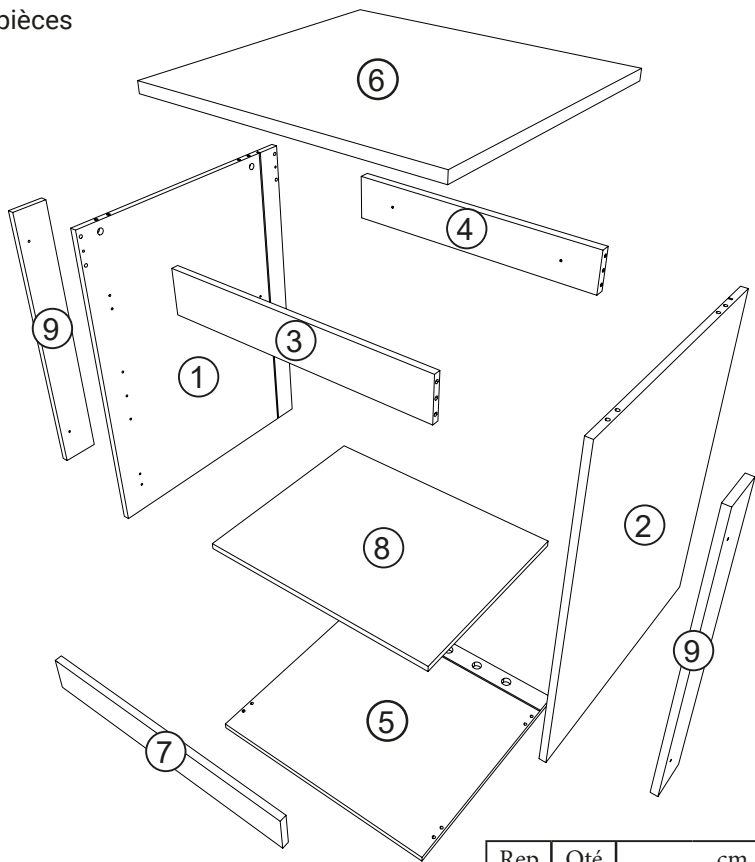

Trier vos quincailleries

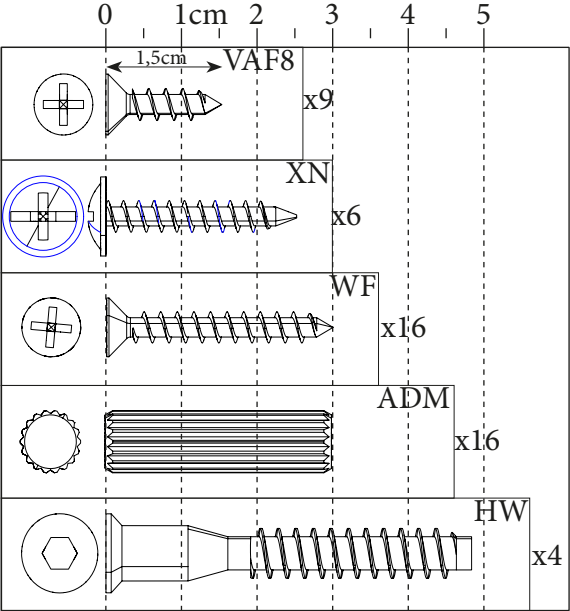

Rep	Qté	cm		
01	1	75,3	59,4	1,5
02	1	75,3	59,4	1,5
03	1	60,2	9,9	1,5
04	1	60,2	9,9	2,2
05	1	63,4	59,5	1,5
06	1	63,4	60	2,2
07	1	60,2	8	1,5
08	1	60,2	47,2	1,5
09	2	66,4	8,6	1,5

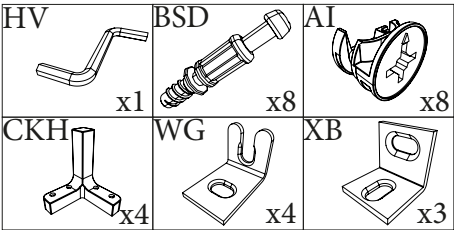

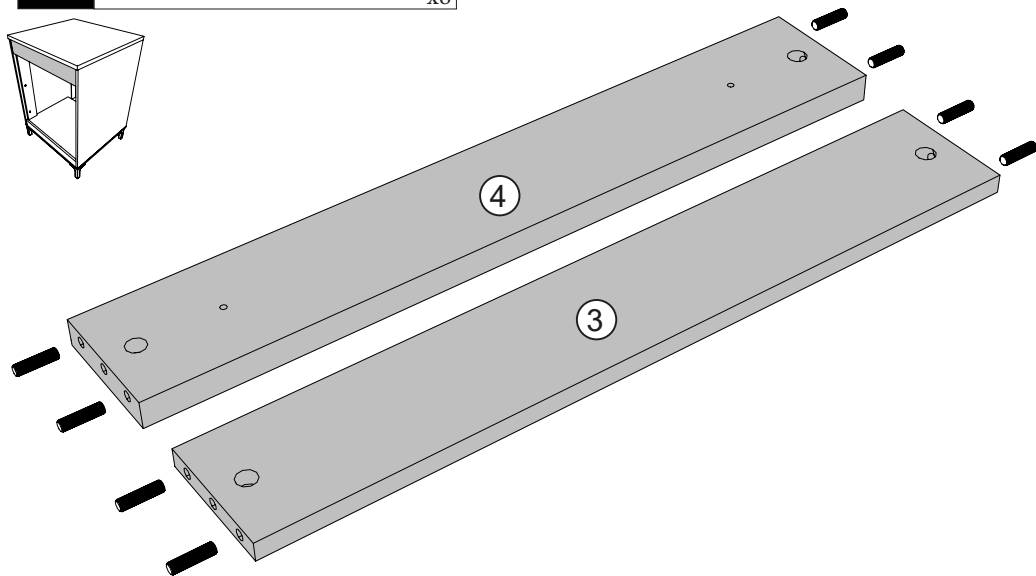
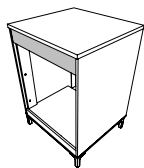
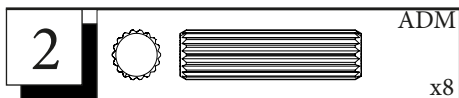
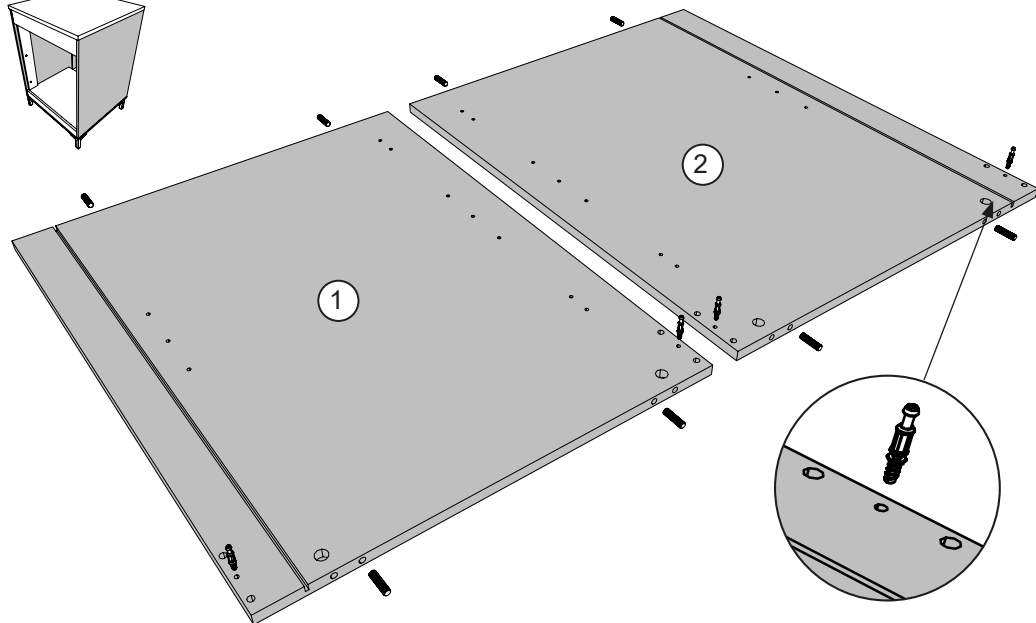
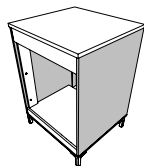
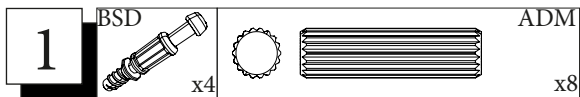

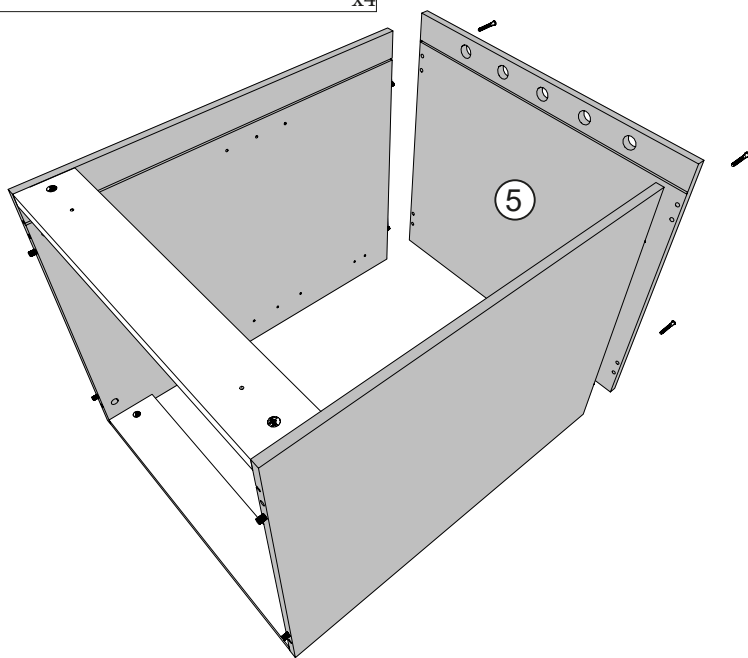
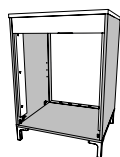
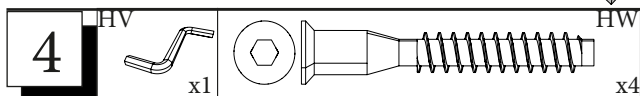
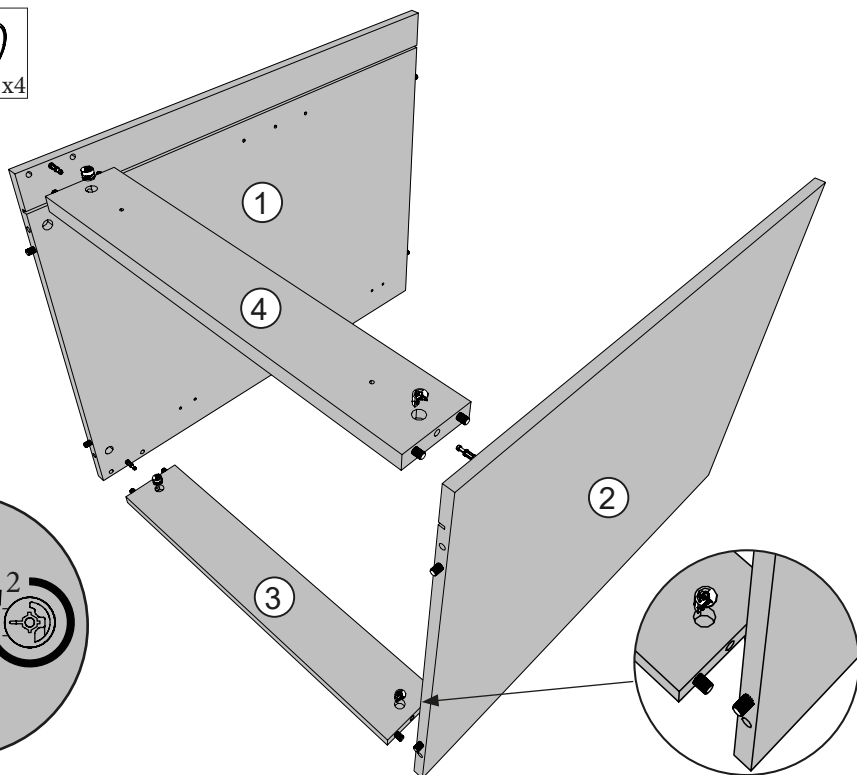
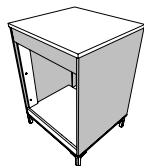

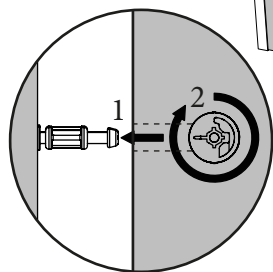
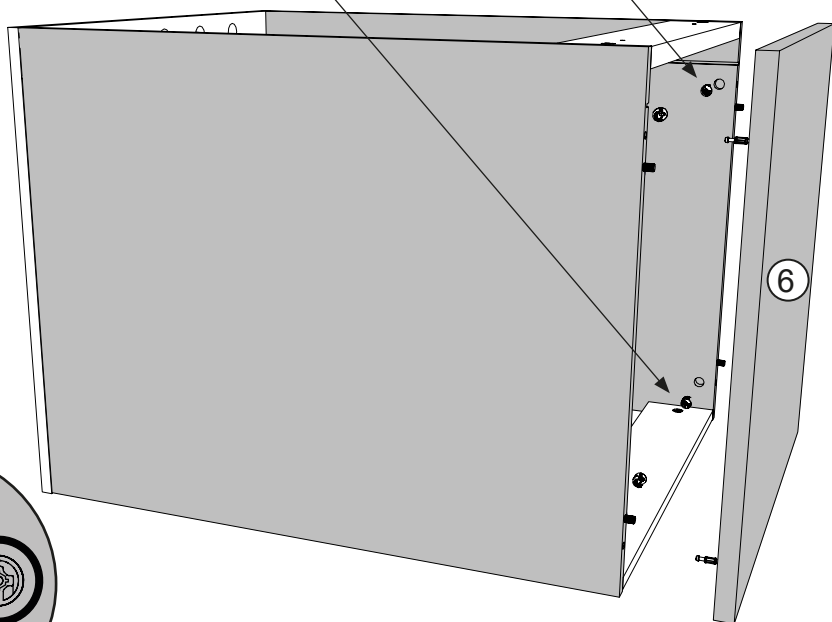
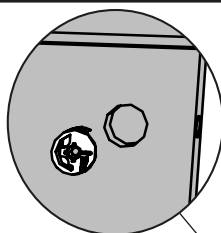
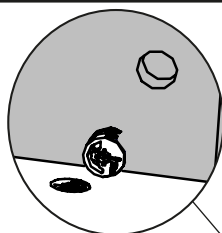
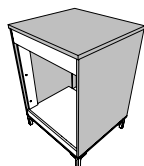
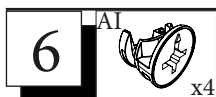
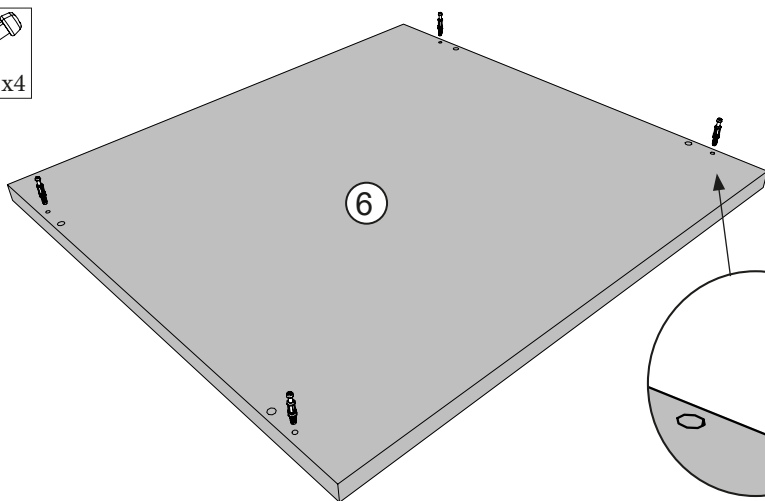
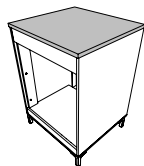
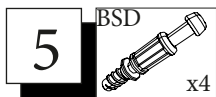

7

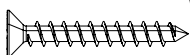

WFCKH

x16



x4

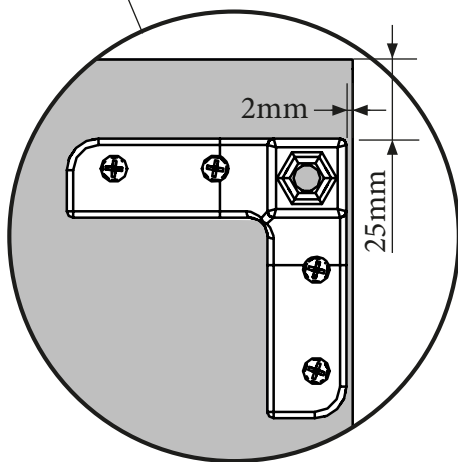
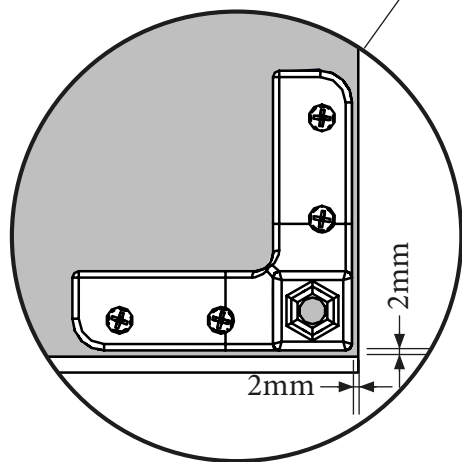
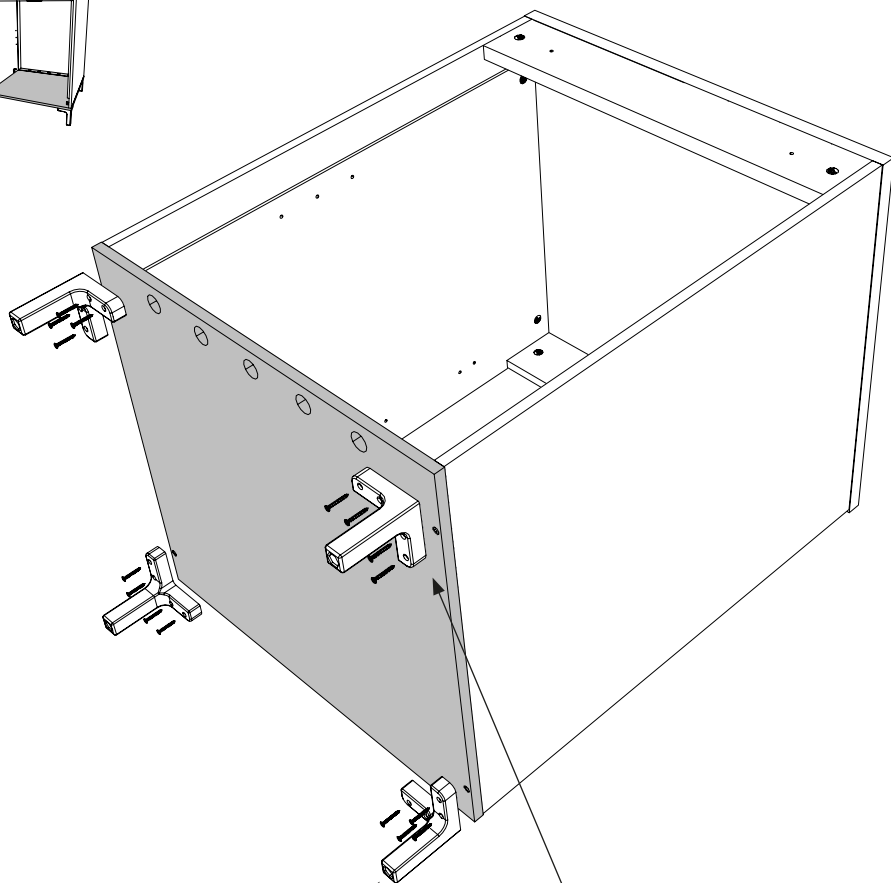

8



1.5cm VAF8 XB

x2



x2

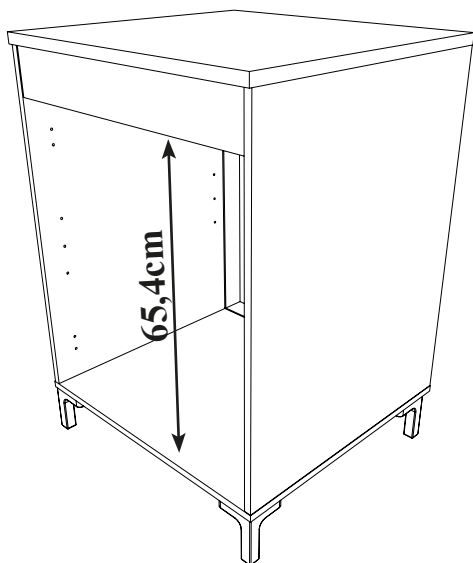
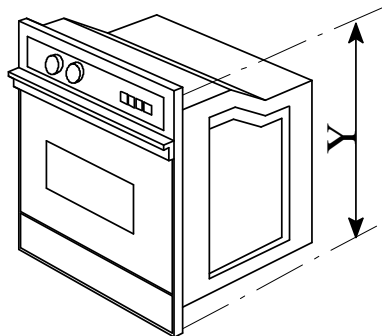
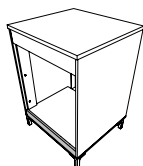

$$X = 65,4\text{cm} - Y - 0,2\text{cm}$$

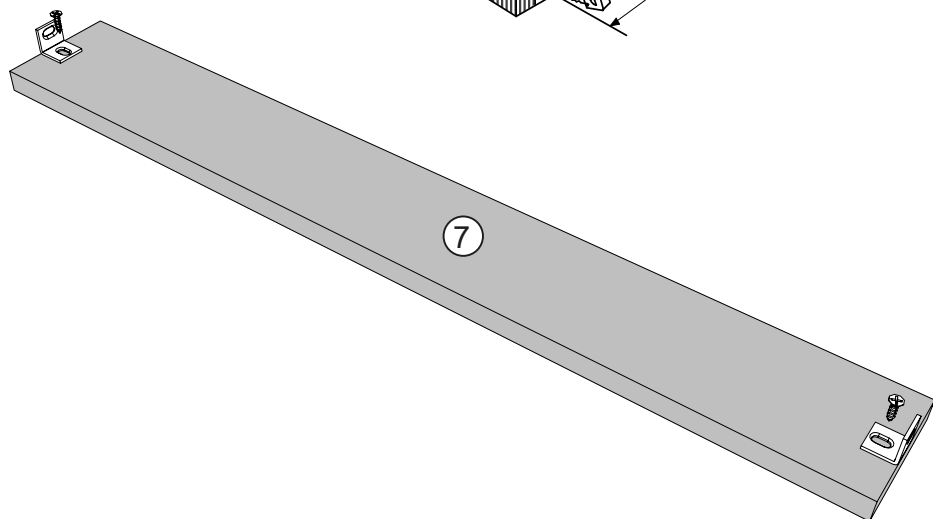
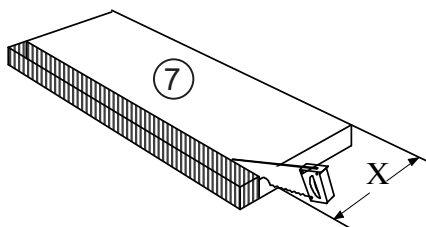



9



1,5cm

→ VAF8

x2

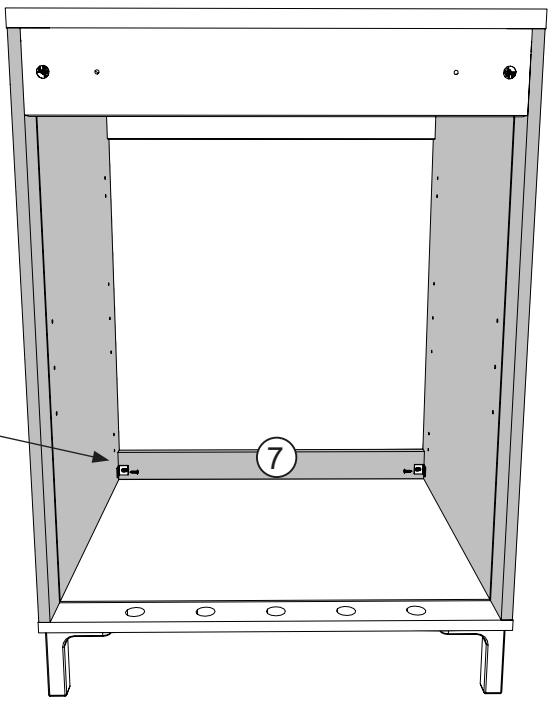
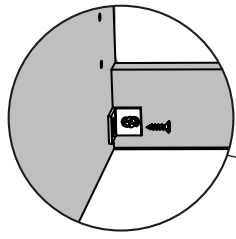
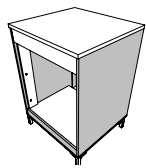

10



1,5cm

→ VAF8 WG



x4

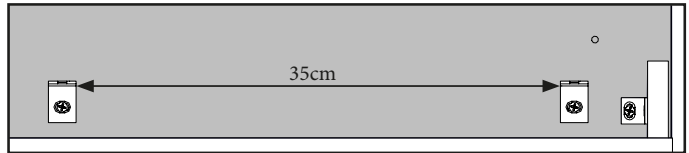
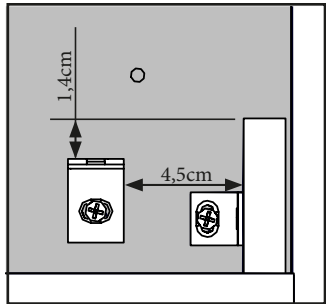
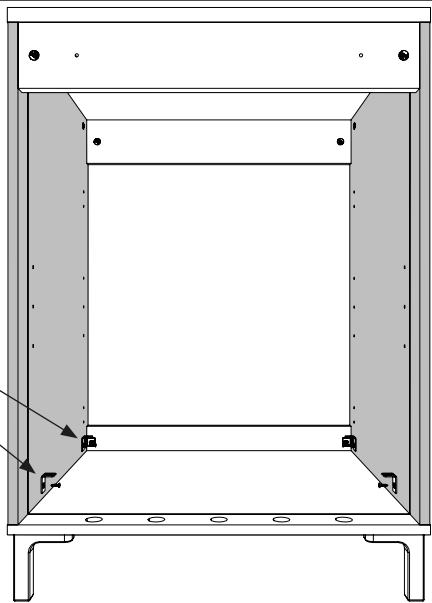
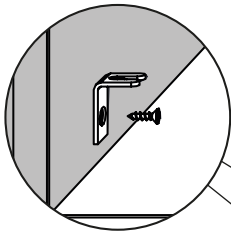
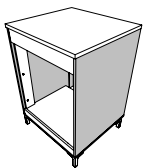

11



1.5cm

VAF8 XB

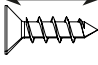

x1



x1

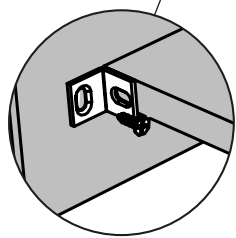
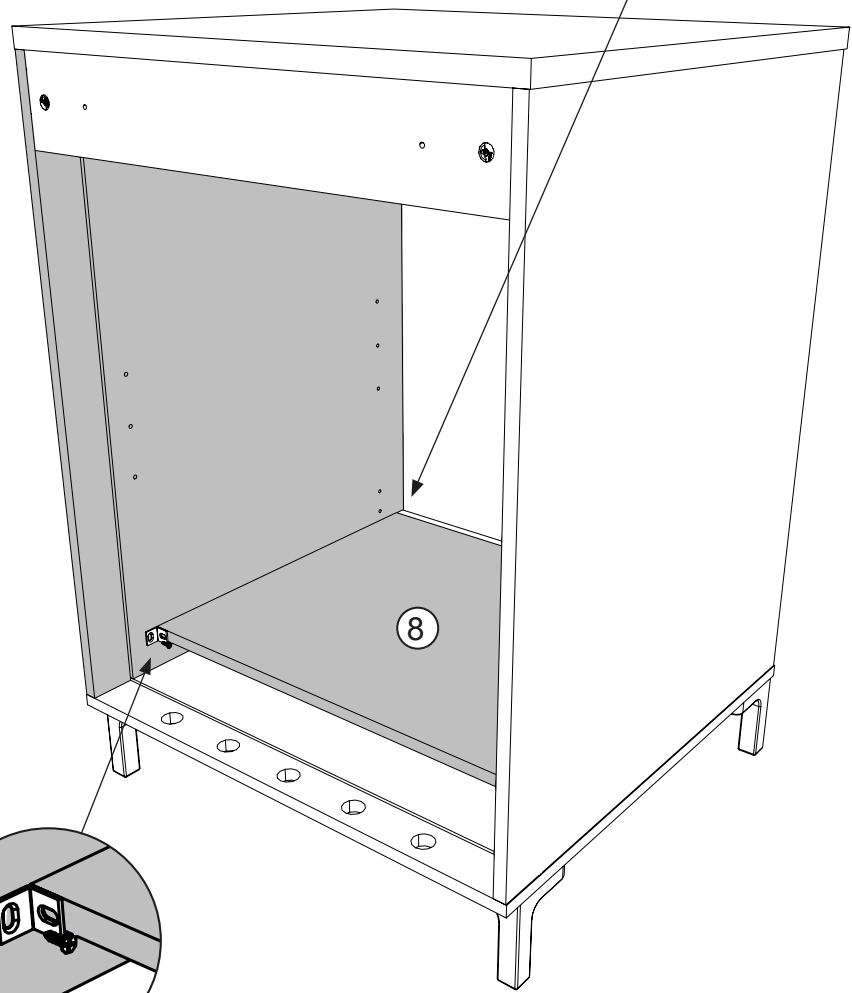
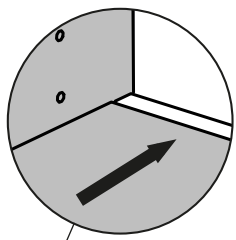
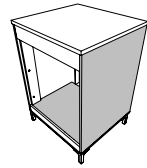

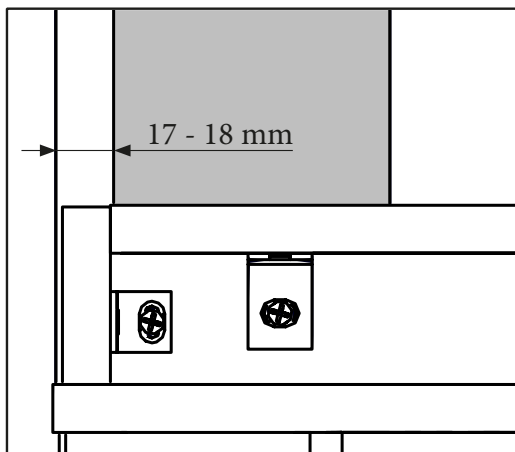
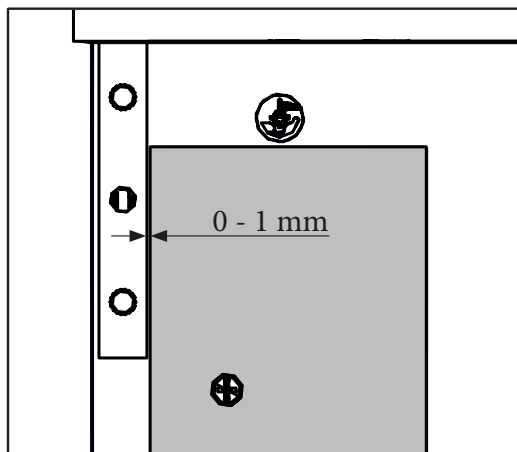
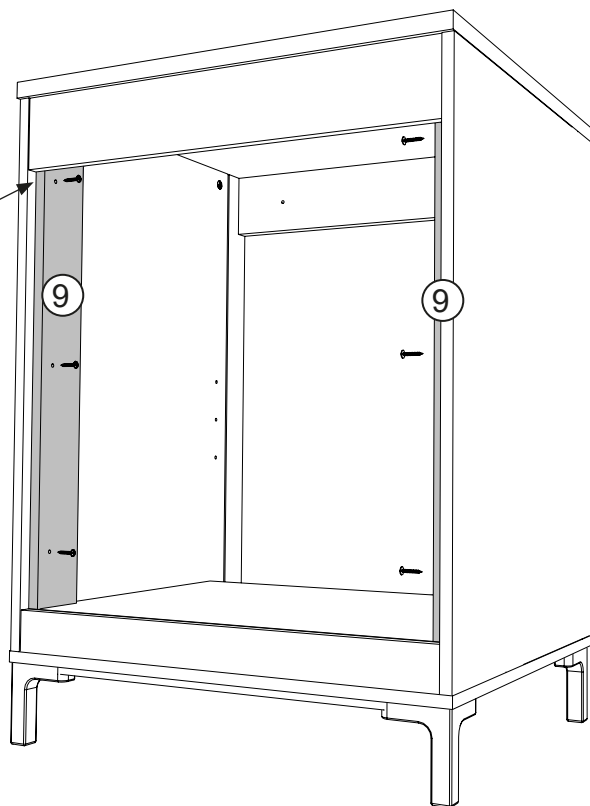
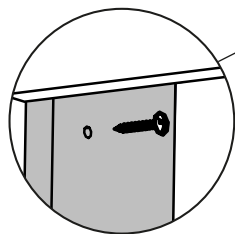
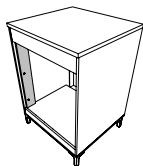
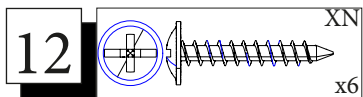

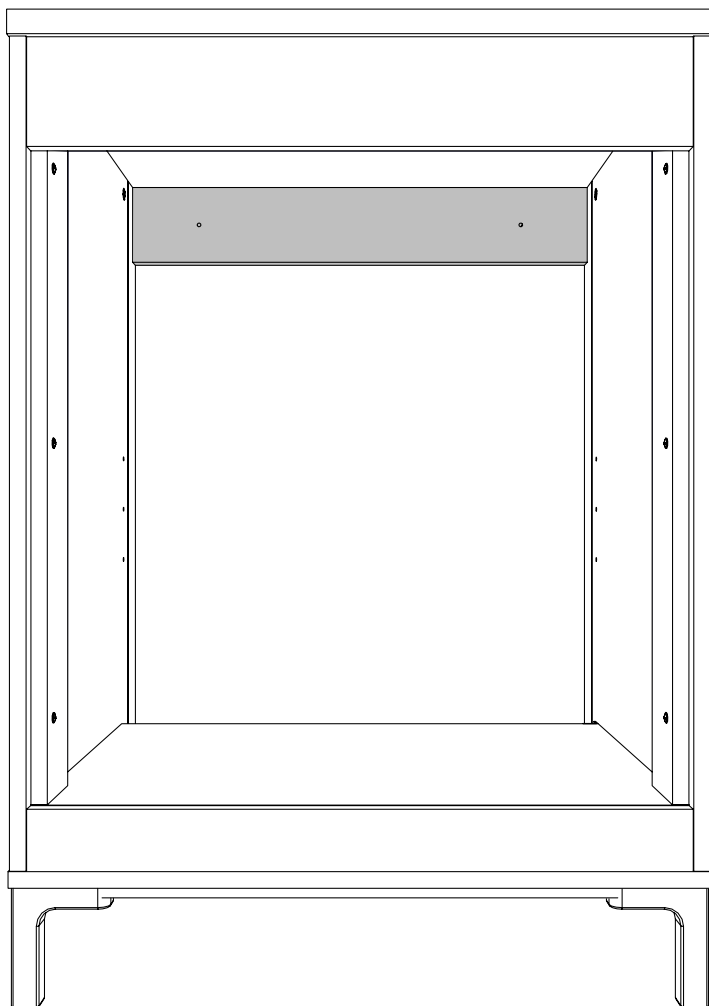

**FR**-Pour votre sécurité : Fixation du meuble au mur.

Attention, la fixation doit être réalisée par une personne compétente car cela nécessite des chevilles adaptées à la nature de votre mur.

**EN**-For your safety : the unit should be secured to the wall.

NB this should be carried out by a competent person as you must use the right rawl plug for your type of wall.



**LE TRI**  
**+ FACILE**



FR

**Pensez à  
donner ou recycler.**



Association

OU



Magasin

OU



Déchèterie

<https://quefairedemesdechets.fr>