



EKIPA

0094NOTIC6186



Bas 40 1P

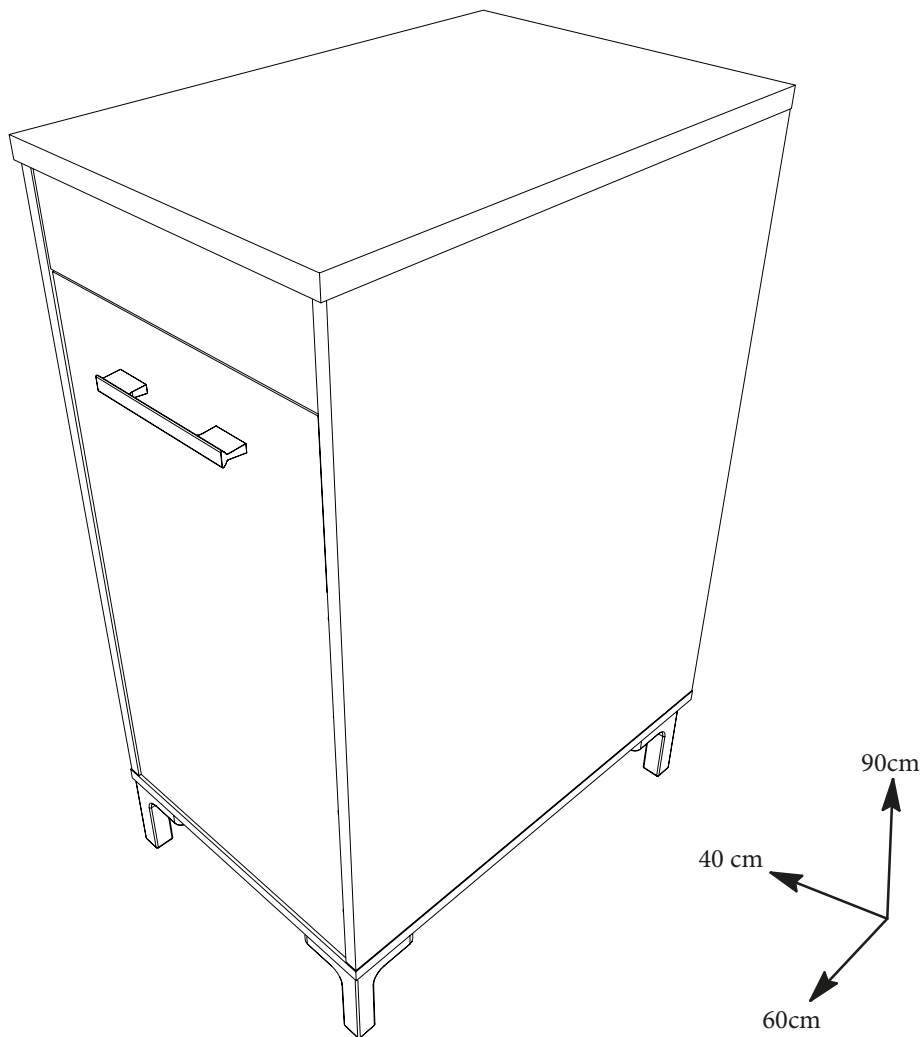

FR Remerciements :

Nous vous remercions d'avoir choisi un meuble créé et fabriqué par Ekipa et espérons qu'il vous donnera entière satisfaction.

EN Thanks :

Thank you for choosing furniture designed and manufactured by Ekipa. We hope you are totally satisfied your purchase.

ES Agradecimientos :

Les damos las gracias por haber elegido un mueble diseñado y fabricado por el Ekipa y esperamos que sea de su total agrado.

DE Danksagung:

Wir danken Ihnen für den Kauf eines Frankreich von der Ekipa entworfenen und hergestellten Möbelstücks und hoffen, dass Sie es zu Ihrer vollkommenen Zufriedenheit finden werden.



Temps de montage : 1h30 **contact@parisot.com**



Conseils de préparation au montage : 15 min

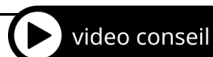

<https://qrco.de/bcJeNz>

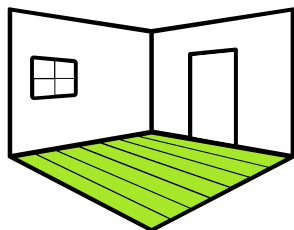

Faire un peu de place

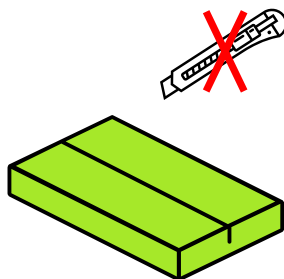

Pas d'outils tranchants

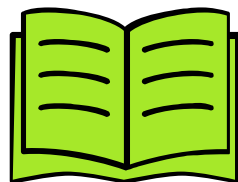

Bien suivre les instructions
de la notice de montage

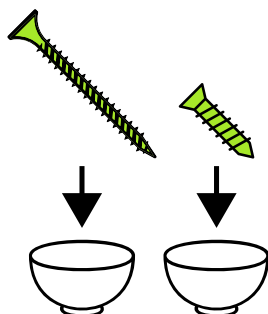

Trier vos quincailleries

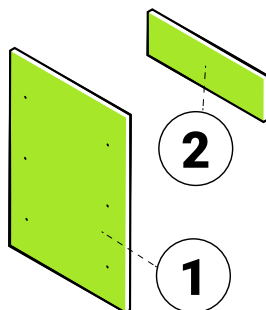

Repérer vos pièces

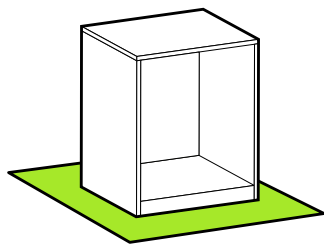

Protéger votre sol

Matériel nécessaire

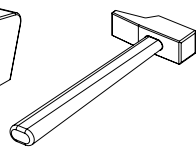
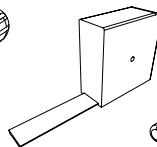
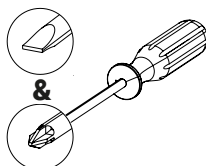
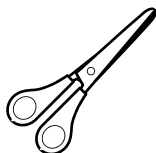
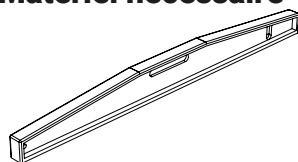

Conseils d'entretien

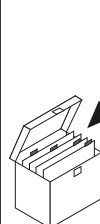

Repérer vos pièces

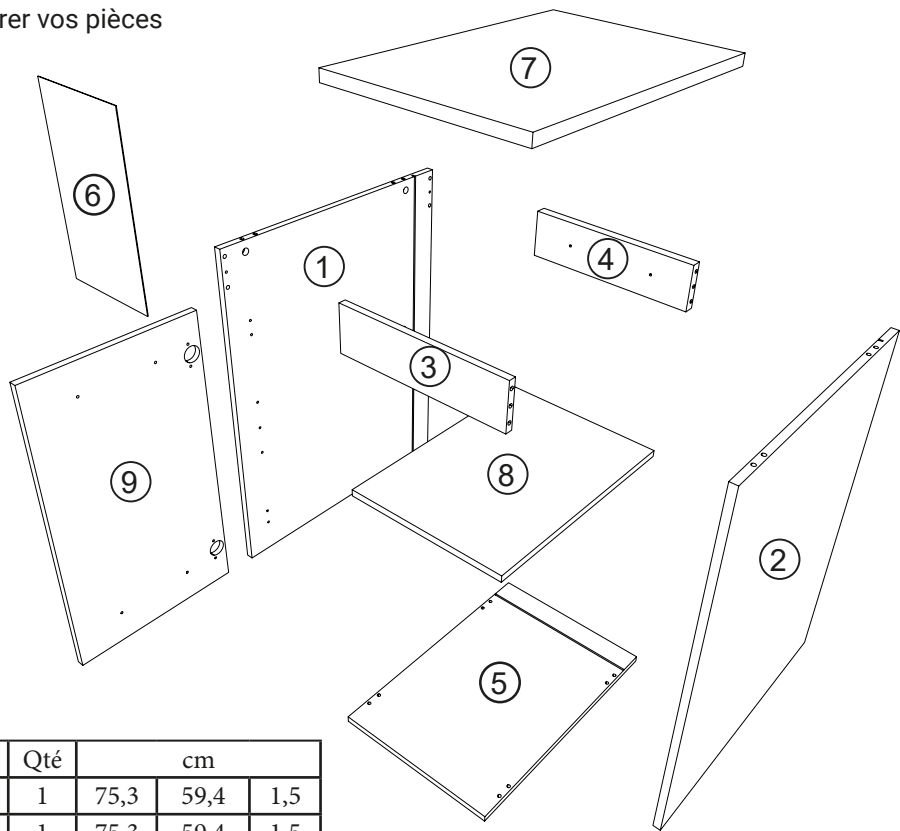

Rep	Qté	cm		
01	1	75,3	59,4	1,5
02	1	75,3	59,4	1,5
03	1	36,8	9,9	1,5
04	1	36,8	9,9	2,2
05	1	40	59,5	1,5
06	1	66	38,3	0,25
07	1	40	60	2,2
08	1	36,8	51,5	1,5
09	1	65	36,3	1,5

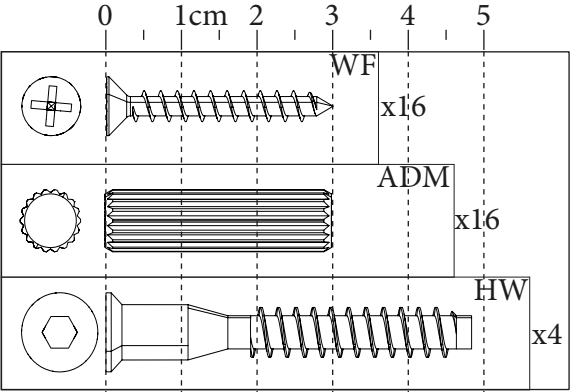

Trier vos quincailleries

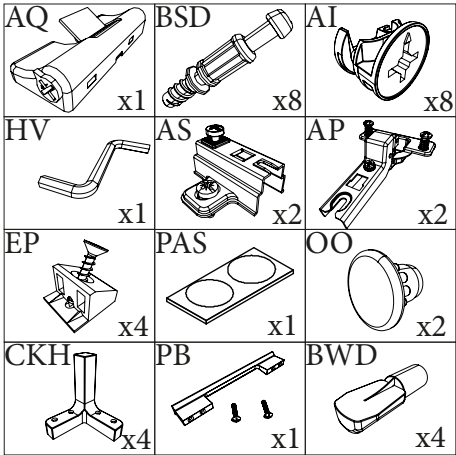

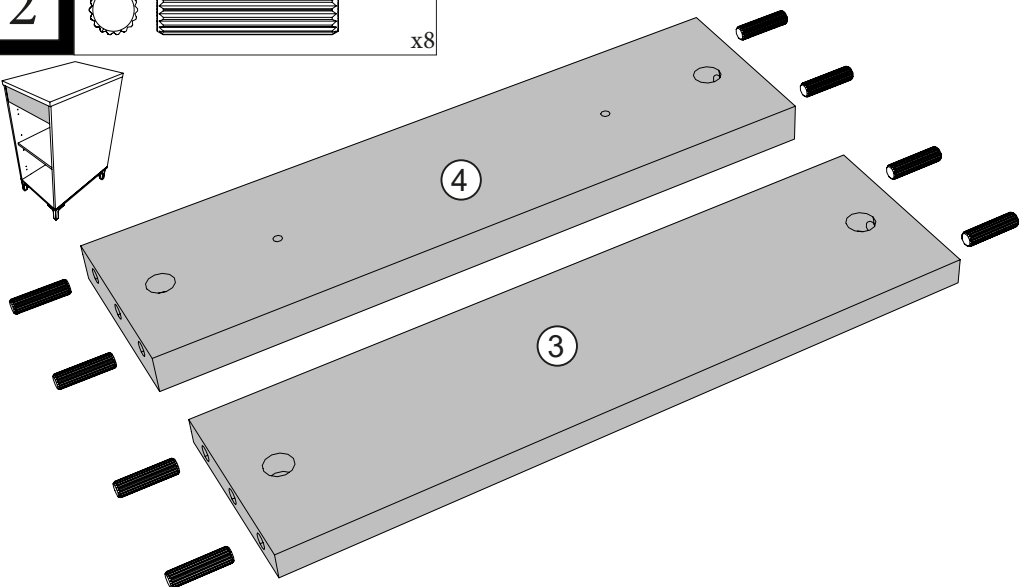
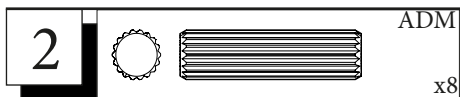
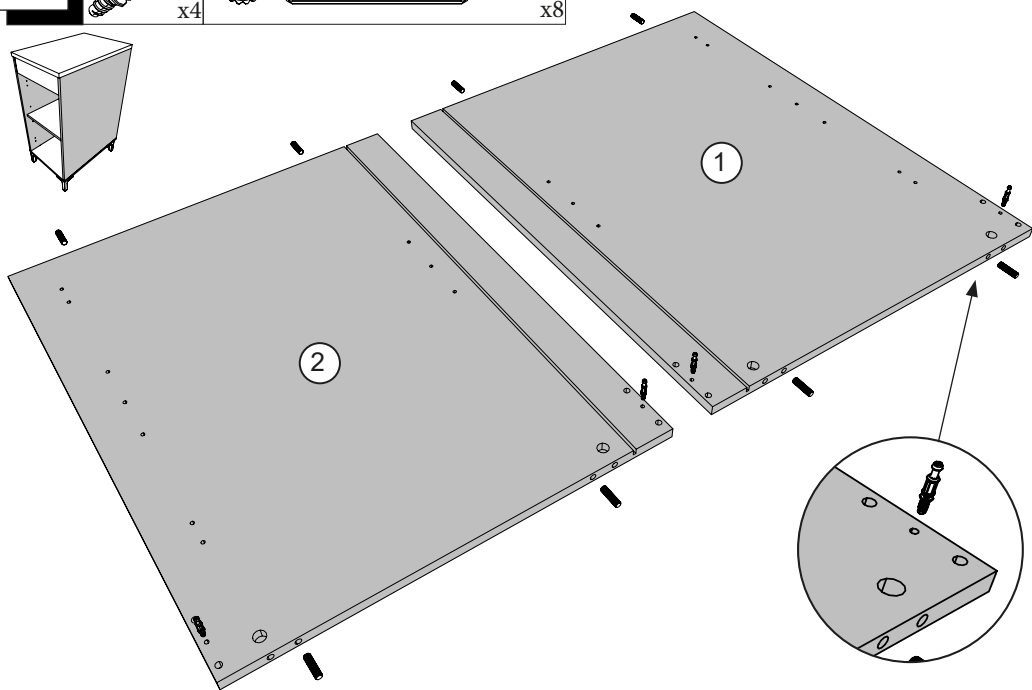
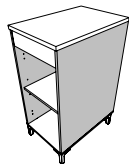
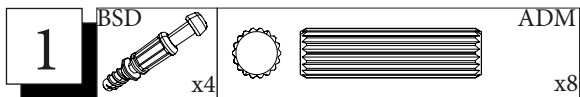

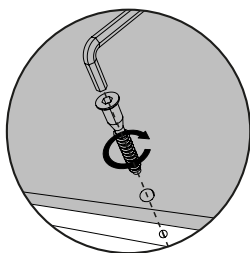
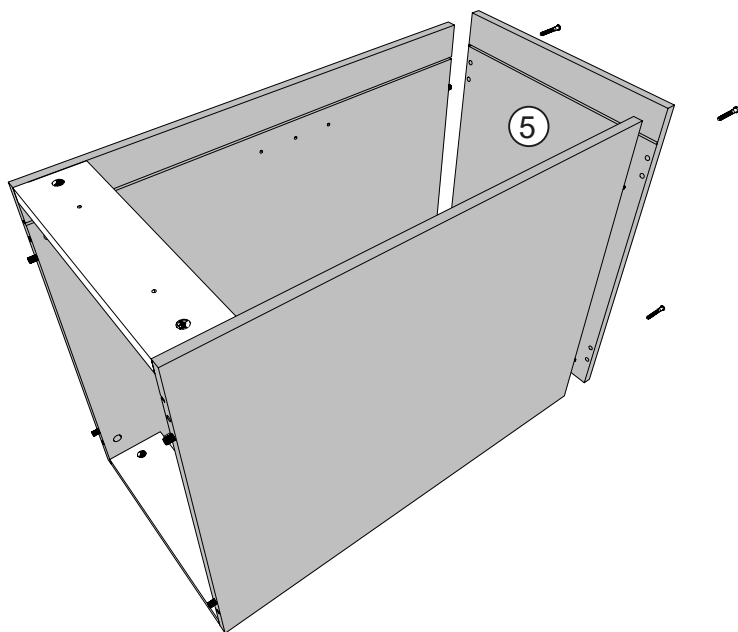
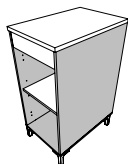
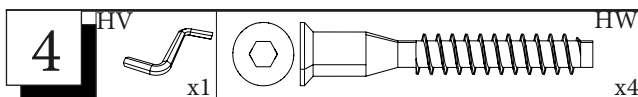
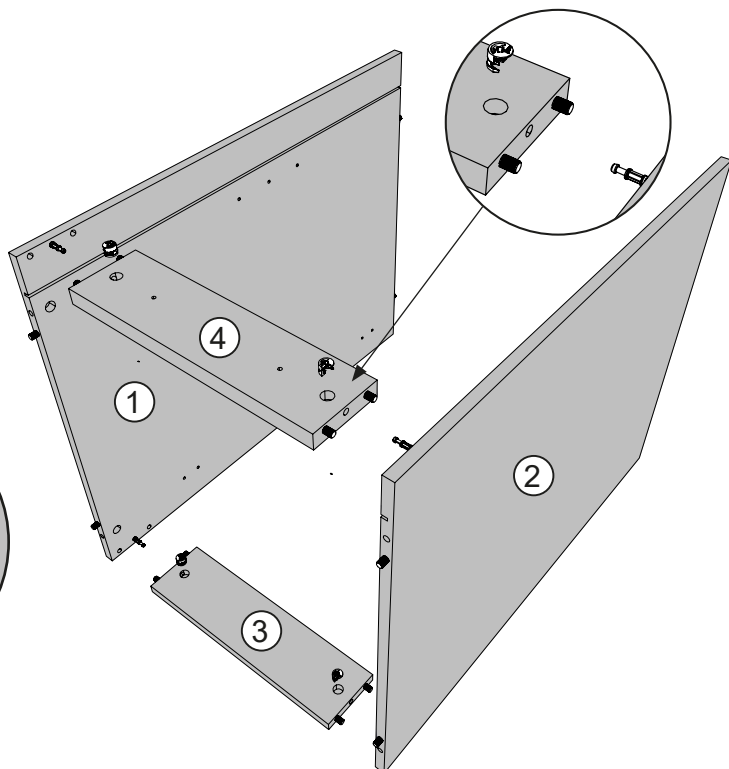
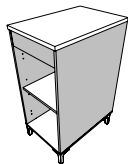

5

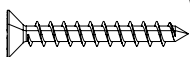

WFCKH

x16



x4

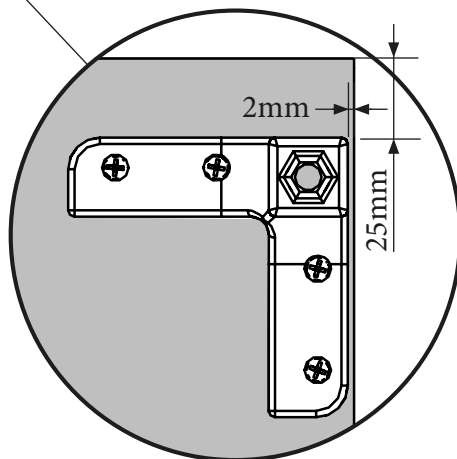
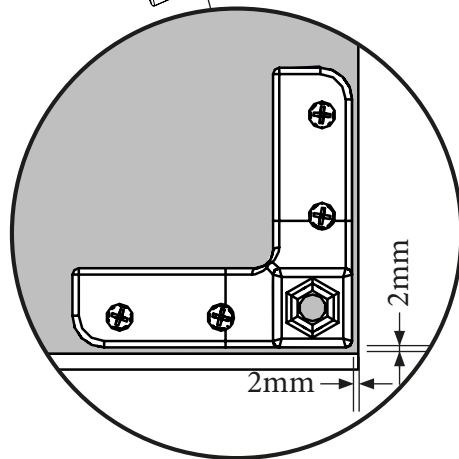
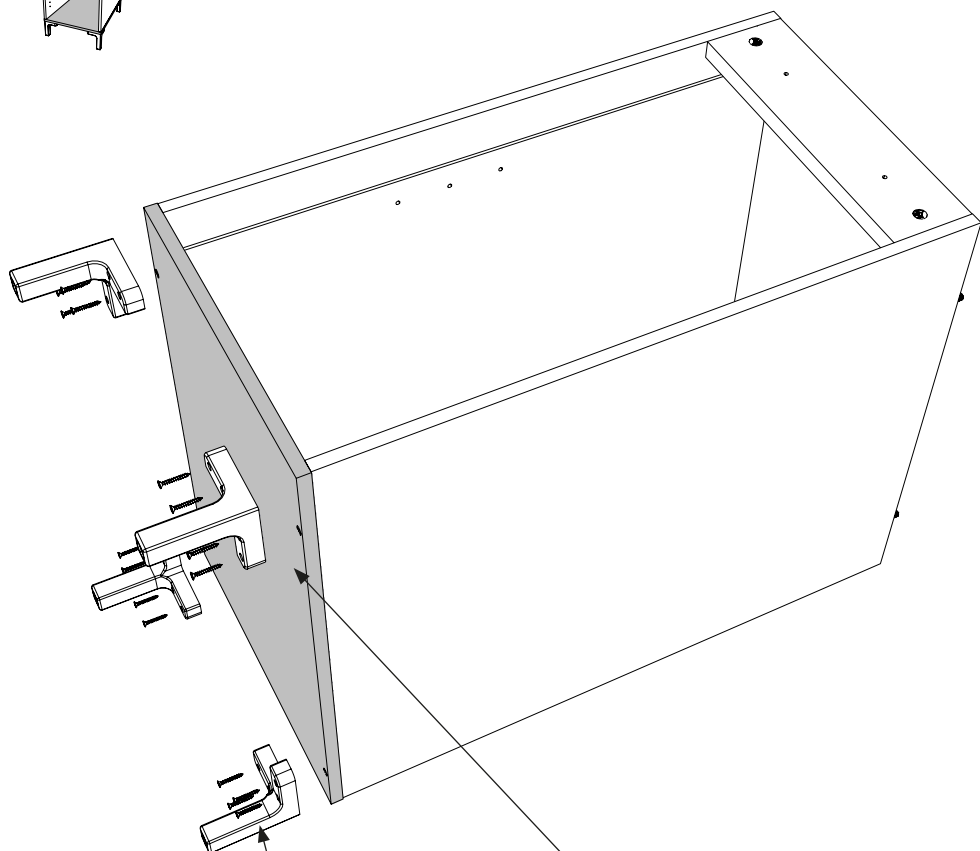
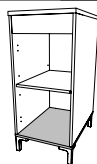

6

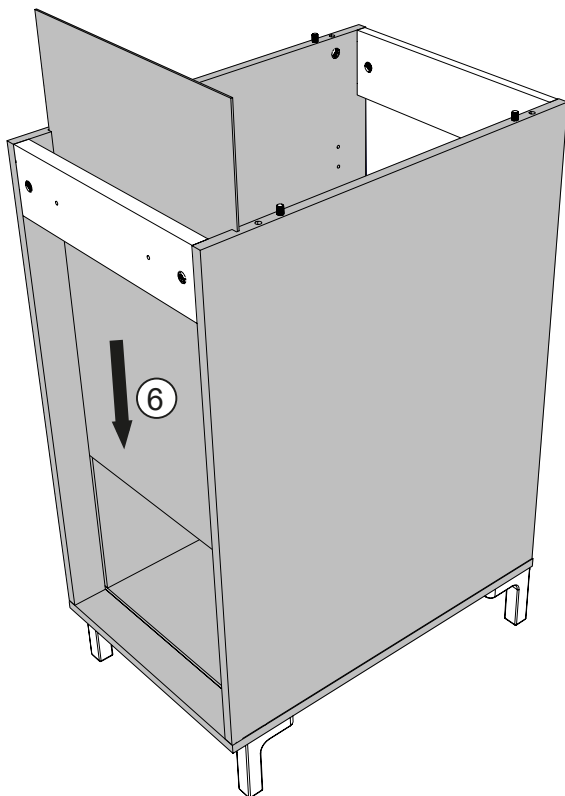
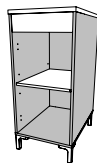

7

BSD



x4

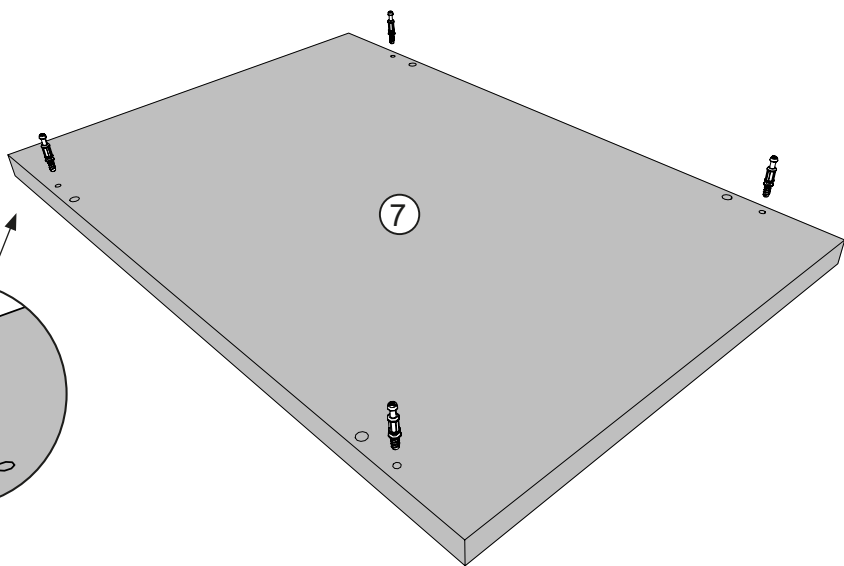

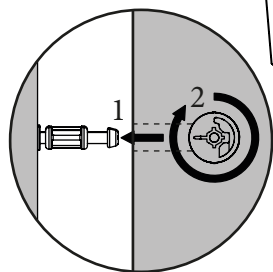
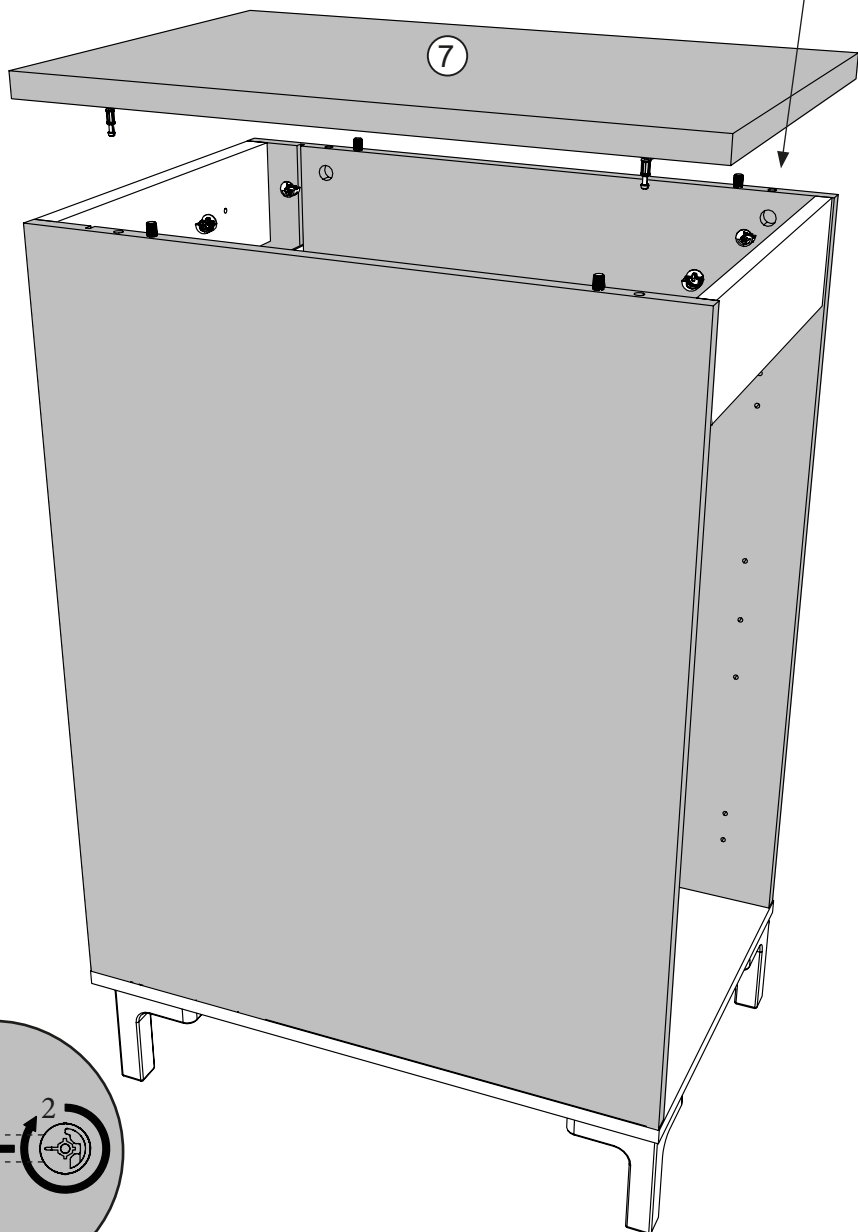

9 EP
x4

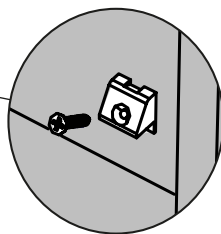
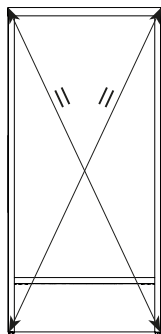
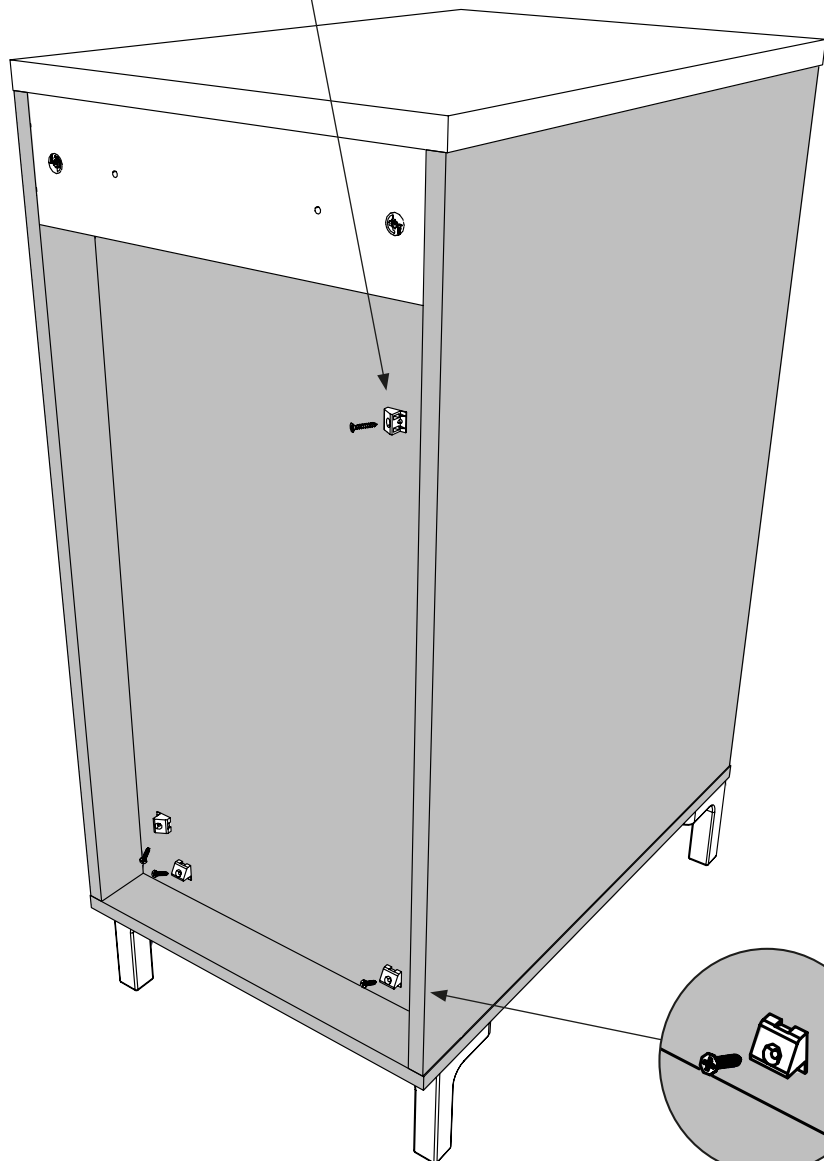
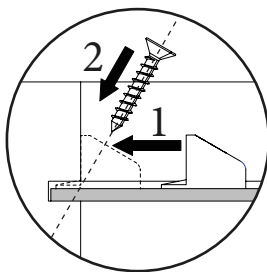
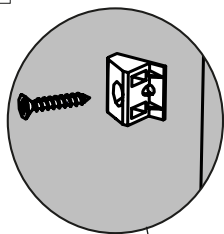
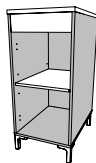

10

FR-Pour votre sécurité : Fixation du meuble au mur.
Attention, la fixation doit être réalisée par une personne compétente car cela nécessite des chevilles adaptées à la nature de votre mur.

EN-For your safety : the unit should be secured to the wall.
NB this should be carried out by a competent person as you must use the right rawl plug for your type of wall.

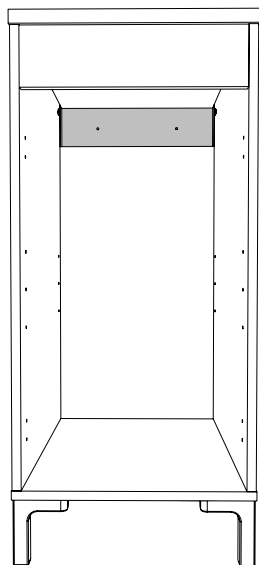

11

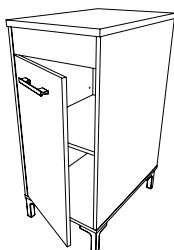
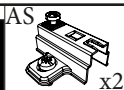

OU

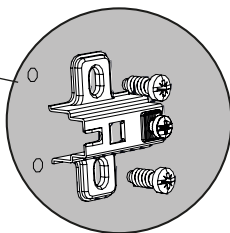
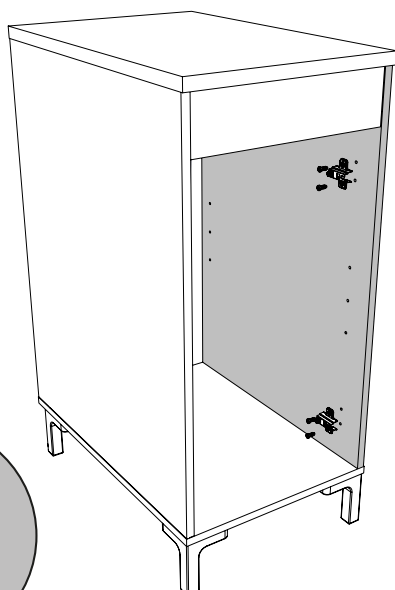
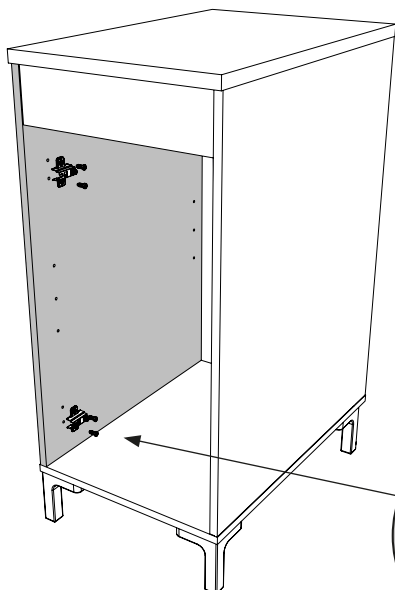
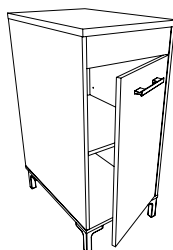

12

PAS

x1

BWD

x4

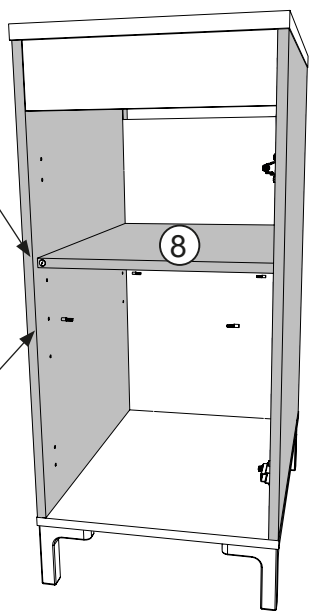
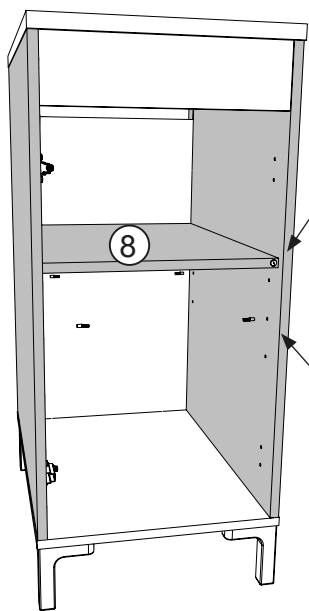
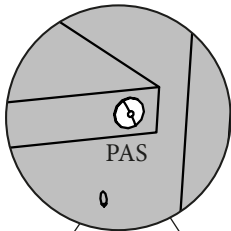
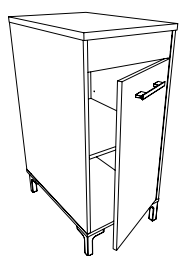
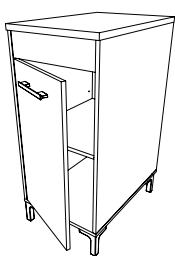
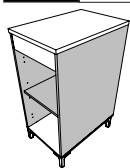
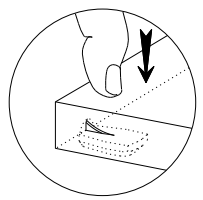

OU

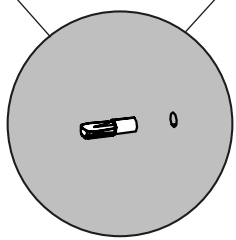

13

AP

x2

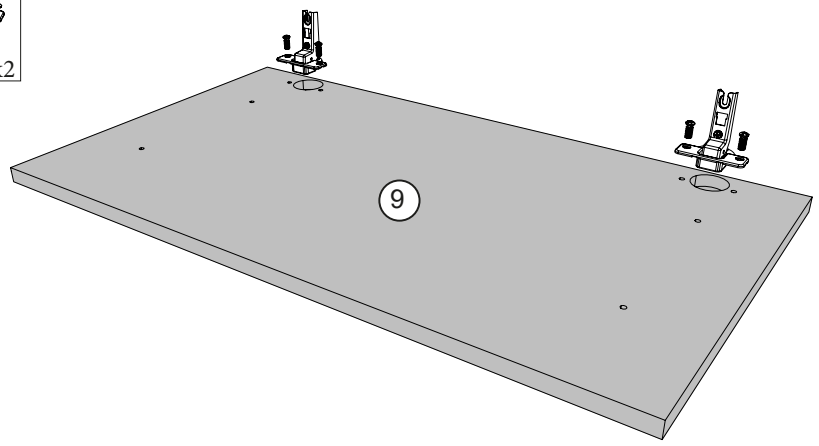

14

OO



x2

PB



x1

AQ

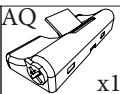

x1

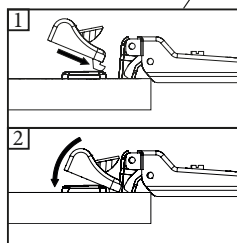
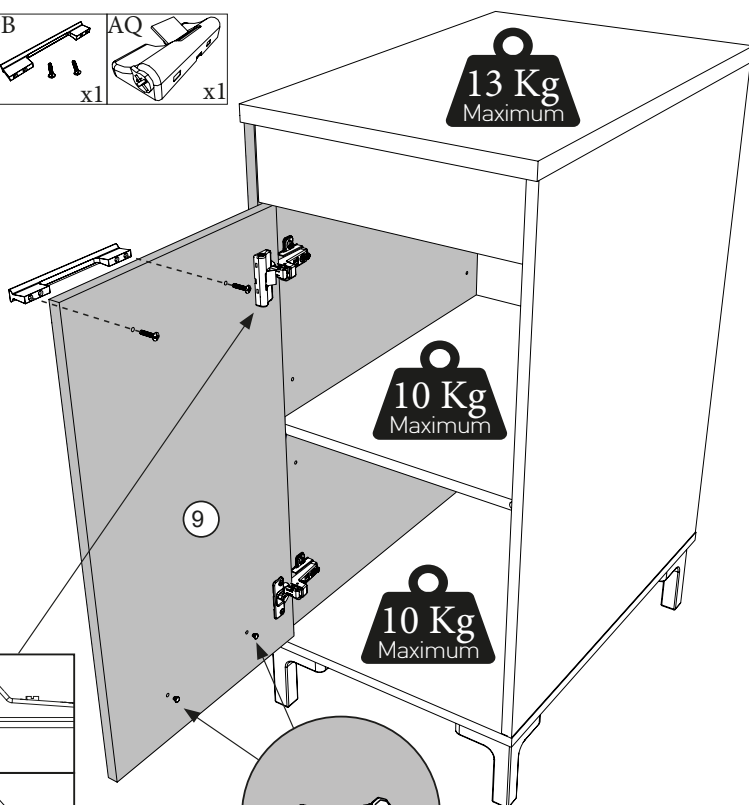
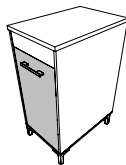

Utiliser une cale pour percer les trous de la poignée

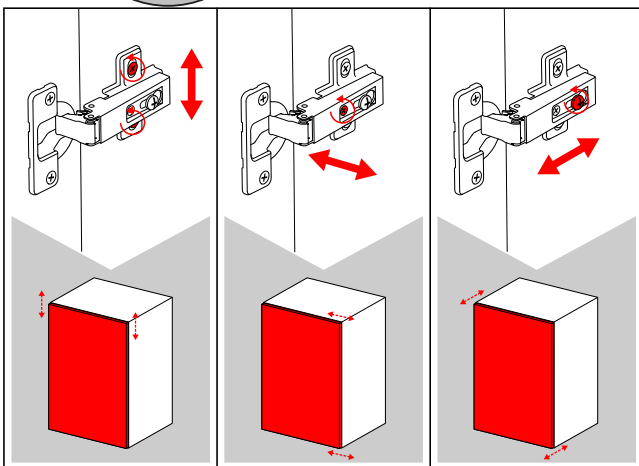
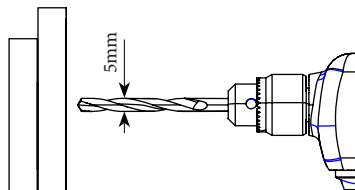

LE TRI
+ FACILE



FR

Pensez à
donner ou recycler.



Association

OU



Magasin

OU



Déchèterie

<https://quefairedemesdechets.fr>